

VIEW FROM THE PARADE GROUND

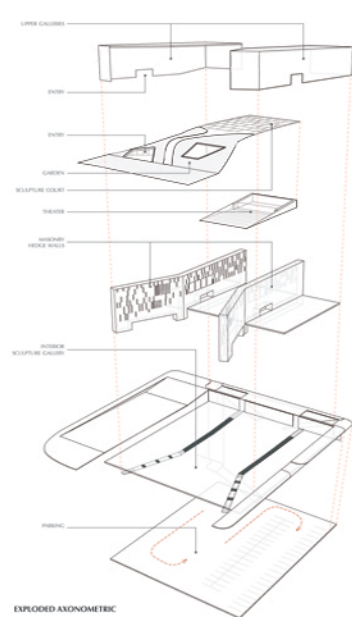

EXPLODED AXONOMETRIC

GATEWAY PROPOSAL FOR A NEW MUSEUM OF CONTEMPORARY ART KUTH | RANIERI ARCHITECTS

Site Selection
Located at the southern edge of the Main Parade Ground, the museum concept proposed in the Gateway Proposal maintains the CAMP Museum site as currently proposed. The introduction of a compelling public destination at the east of the Parade Ground will act as an economic and social catalyst for the entire historic district. Formally, the CAMP Museum will revitalize the Parade Ground's monumental spatial corridor by connecting back to its natural surroundings.

Site Strategy
The iconic and assertive structure is designed to both extend and commandeer the North/South axis that defines the Parade Ground. A broad open courtyard is flanked by museum program to the East and West, asserting a strengthened connection between the formal areas of the Presidio and the breezed trails to the South. At this Gateway, the monumental space of the Parade Ground joins seamlessly with the natural terrain across this new spatial threshold inscribed by the CAMP Museum.

Figure vs. Frame
The idea of building as a frame is as much about the site as it is about the nature of Contemporary Art. You describe the state of Modernity as a time in which the center can no longer hold. This theme, central to contemporary works of art in the Fisher Collection, are brought forward and expressed in the building as an empty figure, a void captured by the flanking walls of the Galleries.

Program and Organization
The building is grounded by means of a contiguous greenway that extends South from the Parade Ground. Sloping up onto a broad plinth, this new ground-plane provides public gardens, circulation and an open-air sculpture court. Located within the plinth are large-open galleries, theater, entry, store and parking. Emerging from the plinth are the Masonry Hedge Walls of the Gallery Wings that define the central open space and contain vertical circulation and mechanical systems.

Scale and Materiality
The building relies on specific contextual strategies, both apparent and latent, that link the contemporary nature of the project to its site and surrounding historic buildings. The Gallery Wings to the East and West are the dominant vertical elements of the proposal and are scaled in relation to the surrounding masonry structures that define the Main Parade Ground. The inner walls of the Gallery Wings are assembled in masonry, extending the Presidio's existing material character and formal order. The outer walls of the building are a light steel frame corresponding with the delicate wood structures to the east. The bunkered Plinth draws on the dramatic earthen and concrete gun turret nestings along the coastal areas of the Presidio.

A Civic Place
The proposed museum site and building configuration define civic engagement with the new cultural and economic life of the Presidio. The image of the institution is envisioned to be both contemporary and timeless, acknowledging the Presidio's history and transformation. The exterior gardens, art plaza and cafes foster an experience of community and support connection to people and place. Galleries, theaters, event + educational spaces, places for cultural events and the scenic beauty of the site animate this new public realm. These ephemeral virtues become, in the end, the most important integrators in the identity of a new civic realm for this noble site.



AERIAL VIEW OF THE SITE

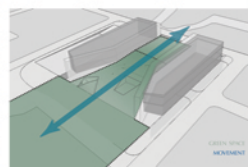

SITE STRATEGY

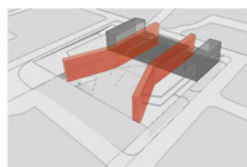

GALLERY ORGANIZATION

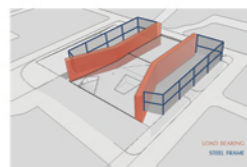

STRUCTURE



CIRCULATION

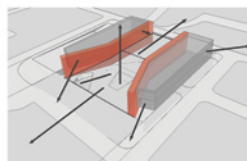

VIEWS

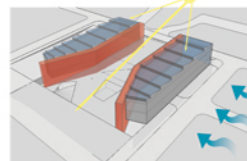

ENVIRONMENT

Contemporary Art Museum at the Presidio



VIEW FROM THE SCULPTURE COURT



INTERIOR GALLERY

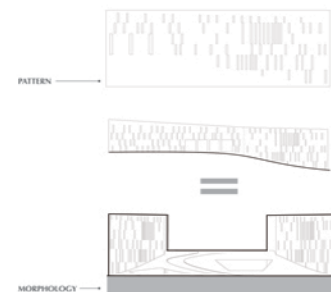

PATTERN

MORPHOLOGY



LOUIS A. KAHN SAN JUAN INSTITUTE (SAN JUAN, CALIFORNIA)



ARCHITECTURAL RENDERING OF THE MUSEUM BUILDING



ARCHITECTURAL RENDERING OF THE MUSEUM BUILDING



ARCHITECTURAL RENDERING OF THE MUSEUM BUILDING



ARCHITECTURAL RENDERING OF THE MUSEUM BUILDING

